

## HCD131006 TYPE

### TYPE

#### HCD 131006

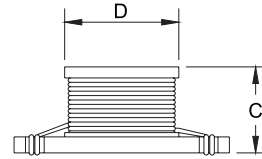
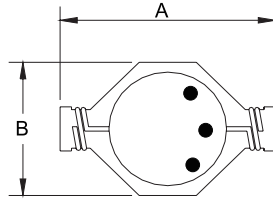

A: 13.21 MAX.  
 B: 9.91 MAX.  
 C: 6.35 MAX.  
 D: 8.38 MAX.

### SPECIFICATION

ITEM	L	DCR	SRF	IDC1	IDC2
HCD131006	( $\mu$ H)	MAX( $\Omega$ )	MIN(MHz)	MAX(A)	MAX(A)
R33M	0.33 $\pm$ 20%	0.002	300	20.0	16.0
R68M	0.68 $\pm$ 20%	0.005	200	13.0	12.0
1R0M	1.0 $\pm$ 20%	0.006	100	11.0	10.0
1R5M	1.5 $\pm$ 20%	0.008	90	9.0	9.0
2R2M	2.2 $\pm$ 20%	0.011	90	7.8	7.4
2R7M	2.7 $\pm$ 20%	0.012	65	7.0	6.6
3R3M	3.3 $\pm$ 20%	0.014	65	6.4	5.9
4R7M	4.7 $\pm$ 20%	0.018	45	5.4	4.8

J:  $\pm$ 5%, K:  $\pm$ 10%, M:  $\pm$ 20%

can design any part to your requirements with different inductance.

\* All parameters as this content presented are subject to final specifications both sides confirmed.